

W

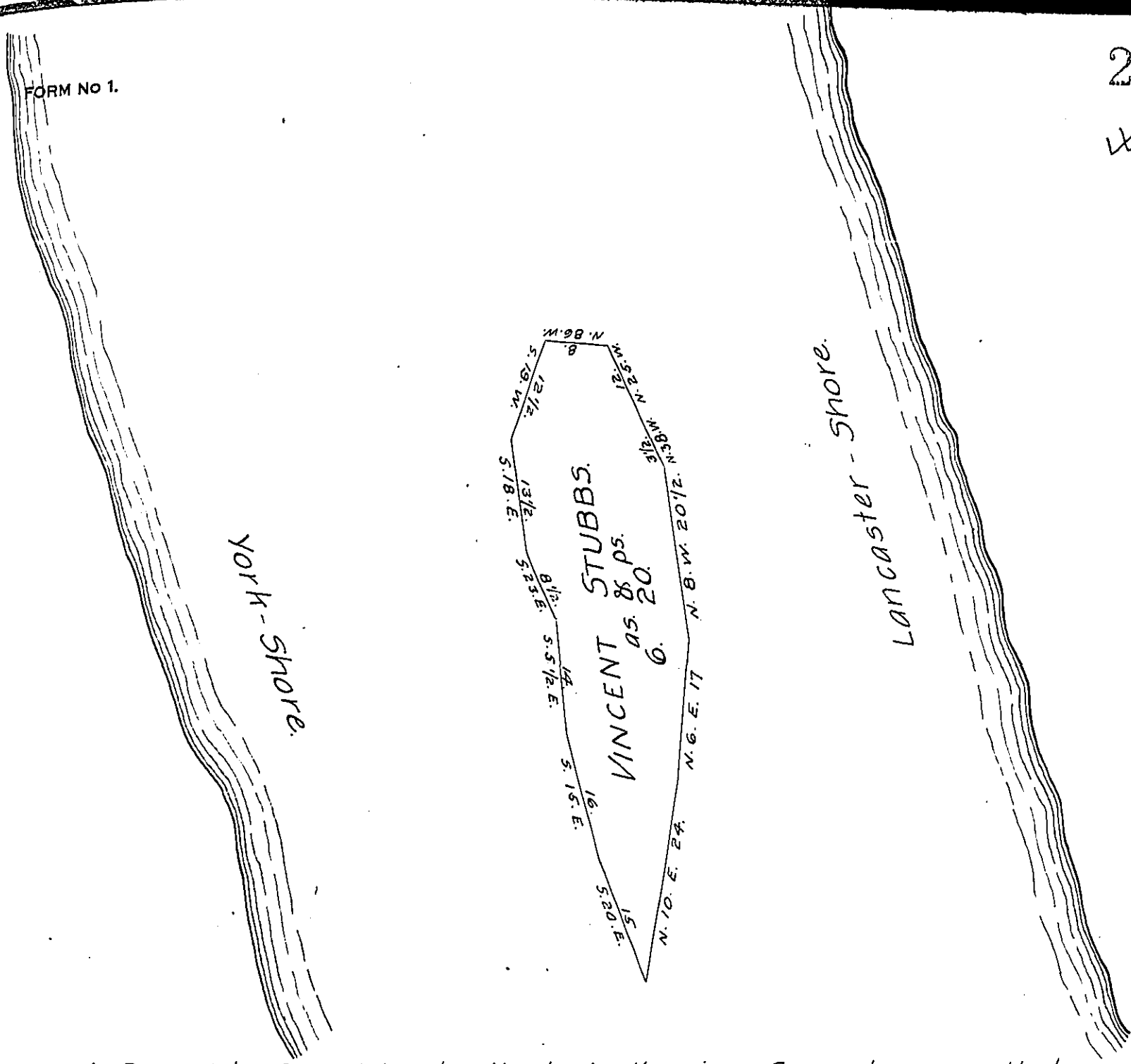

A Draught of an Island Situate in the river Susquehanna, called  
 McDowd's Island Opposite to Land of Margaret Williamson. Situate in  
 Little Britain Township, Lancaster County, containing Six Acres & twenty  
 perches of land, Strict Measure. Surveyed the 6<sup>th</sup> of January 1815, in  
 pursuance of a Warrant dated the 3<sup>d</sup> of January 1815.

pr. Jacob Hibshman, D.S.

To Richard T. Leech, Esq. {  
 Surveyor General }

IN TESTIMONY that the above is a copy of the original remaining on file in  
 the Department of Internal Affairs of Pennsylvania, made  
 conformably to an Act of Assembly approved the 16th day of  
 February, 1833, I have hereunto set my Hand and caused  
 the Seal of said Department to be affixed at Harrisburg,  
 this fifth day of March 1907.

*Isaac R. Brown*  
 Secretary of Internal Affairs.